



SAON

ACCESSORI _ Accessories _ Accessoires _ Accessoires

Una collezione completa di oggettistica da appoggio, dalle forme semplici e rigorose, realizzati nei materiali più vari.

Designers: Opendesignitalia _ Spiral product design _ London _ Mimmo Lorella

A complete collection of free-standing objects,

characterised by simple and rigorous shapes, made using a large variety of materials.

Designers: OpenDesignItalia - Spiral Product Design - London - Mimmo Lorella

Une collection complète d'objets à poser, aux formes simples et précises, réalisés dans différents matériaux.

Designers : OpenDesignItalia - Spiral Product Design - Londres - Mimmo Lorella

Eine vollständige Kollektion von Ablagen mit schlichten, strengen Formen, die in den verschiedensten Materialien hergestellt werden.

Designer: OpenDesignItalia - Spiral Product Design - London - Mimmo Lorella

Finiture _ Finishes _ Finitions _ Afwerkingen

Alluminio verniciato

Painted aluminium

Aluminium laqué

Lackiertem Aluminium

Alluminio verniciato

Painted aluminium

Aluminium laqué

Lackiertem Aluminium

Acciaio inox lucido

Polished stainless steel

Acier inoxydable brillant

Poliert Edelstahl



.09



.23







.29

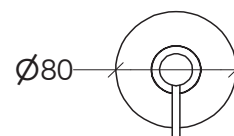
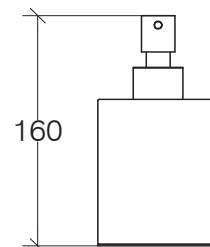

SAON**44018****Dosasapone 250 ml**

Soap dispenser 250 ml / Distributeur savon liquide 250 ml / Seifenspender 250 ml



cod. 44018				Alluminio verniciato Painted aluminium Aluminium laqué Lackiertem Aluminium
EAN 8005049320920	0,335	2,448	1	

Peso e volume lordo / Gross weight and volume / Poids et volume brut / Bruttogewicht und Volumen



Made in Italy
Made in Italy
Made in Italy
Made in Italy

PULIZIA e MANUTENZIONE

Pulire con un sapone neutro, applicare con un panno umido, strofinare leggermente, lasciar agire brevemente e quindi sciacquare con acqua. Infine lucidare con un panno morbido e asciutto. Per macchie di calcare pulire con una soluzione di acqua (80%) e aceto bianco (20%), per un'azione igienizzante aggiungere alla soluzione del bicarbonato di sodio. Asciugare sempre la superficie in modo da evitare le macchie derivanti dall'acqua.

Avvertenze: La resistenza alla corrosione al nichel-cromo si riduce sotto l'azione di acidi e composti alogenati (cloruri, bromuri, ioduri). Non utilizzare mai soluzioni a base di cloro (candeggina), detersivi o spugne abrasive. Evitare la ruggine causata da materiali esterni (ad es. paglietta di acciaio ecc.).

CARE and MAINTENANCE

Clean with a mild soap, apply with a damp cloth, rub lightly, leave it briefly and then rinse with water. Finally polish with a soft, dry cloth. To remove the limestone stains, clean with a solution of water (80%) and white vinegar (20%), to sanitize add baking soda. Always dry the surface in order to prevent stains caused by water. Warnings: The corrosion resistance of the steel is reduced by acids and halogen compounds (chlorides, bromides, iodides). Never use solutions containing chlorine (bleach), detergents or abrasive sponges. Prevent rust caused by external materials (eg. Scouring steel, etc..).